

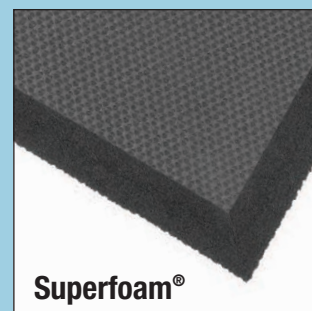

Soil Guard™



Wayfarer™



Superfoam®



Airug®



Marble Sof-tyl™



Cushion Trax®



Arrow Trax™



Sabre™



Uptown™/Boulevard™



Logo Mats



Guzzler™

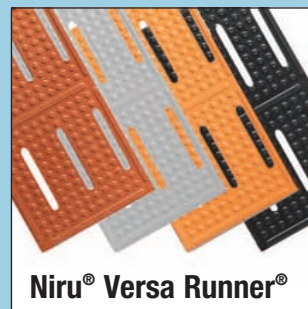

Niru® Versa Runner®



Cushion-Ease®



Sanitop®



Modular Lok-Tyle™



V-Groove Runner

NOTRAX®
FLOOR MATTING



Superior Manufacturing Group, Inc.
5655 W. 73rd St. • Chicago, IL 60638
Phone: 800.621.2802 Fax: 800-322-7105
Email: info@notrax.com • Web: www.notrax.com

HEALTHCARE MATTING APPLICATION GUIDE



LOCATION		ITEM # - PRODUCT	
1	MAIN ENTRANCE (OUTSIDE)	231 - Prelude™ GREENTRAX 340 - Soil Guard™ GREENTRAX 266 - Wayfarer™ Custom GREENTRAX	
2	MAIN ENTRANCE (INSIDE)	117 - Heritage Rib® 118 - Arrow Trax™ GREENTRAX 132 - Estes™ GREENTRAX 136 - Polynib™ GREENTRAX 138 - Uptown™ GREENTRAX 139 - Boulevard™ GREENTRAX 141 - Ovation™ GREENTRAX	146 - Encore™ GREENTRAX 150 - Aqua Trap® (anti-microbial) GREENTRAX 161 - Barrier Rib™ (anti-microbial) GREENTRAX 166 - Guzzler™ GREENTRAX 370 - Master Trax™ Logo Mats
3	RECEPTION DESK/LOBBY	T17 - Superfoam® 130 - Sabre™ Decalon® 170 - OrienTrax™ 166 - Guzzler™ (drinking fountain) GREENTRAX	410 - Airug® 470 - Marble Sof-Tyle™ REDSTOP 970 - Marble Sof-Tyle™ Grande™ REDSTOP Logo Mats
4	OFFICE/ RECORDS	T17 - Superfoam® 410 - Airug® 470 - Marble Sof-Tyle™ REDSTOP 479 - Cushion Trax® REDSTOP	769 - Clear Trax™ 825 - Cushion-Stat™ 970 - Marble Sof-Tyle™ Grande™ REDSTOP
5	SURGERY/ CLEAN ROOMS	416 - Anti-Microbial Matting 662 - Solutions™ (Anti-bacterial)	
6	LABS	T17 - Superfoam® 470 - Marble Sof-Tyle™ REDSTOP 479 - Cushion Trax® REDSTOP 662 - Solutions™ (Anti-bacterial)	970 - Marble Sof-Tyle™ Grande™ REDSTOP 975 - Cushion Trax® Ultra REDSTOP 979 - Saddle Trax™ REDSTOP
7	EMERGENCY (Outside/Inside Entrances see location #1)	T17 - Superfoam® 266 - Wayfarer™ Custom (vending) GREENTRAX 166 - Guzzler™ (vending) GREENTRAX 410 - Airug®	411 - Sof-Tred™ 447 - Comfort-Eze 470 - Marble Sof-Tyle™ REDSTOP 970 - Marble Sof-Tyle™ Grande™ REDSTOP
8	AUDITORIUM	105 - Chevron 117 - Heritage Rib®	130 - Sabre™ Decalon® 769 - Clear Trax™
9	MATERNITY/ NURSERY	T17 - Superfoam® 410 - Airug® 447 - Comfort-Eze 470 - Marble Sof-Tyle™ REDSTOP 970 - Marble Sof-Tyle™ Grande™ REDSTOP	562 - Sanitop® MICROSTOP (Red only) 662 - Solutions™ (Anti-bacterial)
10	NURSES STATION	T17 - Superfoam® 410 - Airug® 447 - Comfort-Eze 470 - Marble Sof-Tyle™ REDSTOP 970 - Marble Sof-Tyle™ Grande™ REDSTOP	
11	OUTSIDE PATIO	117 - Heritage Rib® 118 - Arrow Trax™ GREENTRAX 146 - Encore™ GREENTRAX 166 - Guzzler™ GREENTRAX 167 - Portrait™ GREENTRAX	168 - Opus™ GREENTRAX 340 - Soil Guard™ GREENTRAX
12	KITCHEN/ DINING/ DELIVERY	T17 - Superfoam® 117 - Heritage Rib® 118 - Arrow Trax™ GREENTRAX 130 - Sabre™ Decalon® (See APEX Foodservice Matting line for additional products: T11, T12, T15, T18, T22) 543 - Cushion-Tred™ MICROSTOP (Gray & Red only) 550 - Cushion-Ease® MICROSTOP (Red only) 556 - Cushion-Ease® Solid MICROSTOP (Red only)	562 - Sanitop® MICROSTOP (Red only) 680 - Safety Trax™ 755 - Niru® Versa Runner® MICROSTOP 758 - Niru® Knob-Top Runner™ MICROSTOP 765 - Deep Freeze Mat™ (walk-in freezer) Cutting Boards
13	WEIGHT ROOM/ REHAB/LOCKER ROOMS	045 - Weight Room Matting 266 - Wayfarer™ Custom GREENTRAX 411 - Sof-Tred™ 523 - Modular Lok-Tyle™	531 - Safety Grid™ 755 - Niru® Versa Runner® MICROSTOP 758 - Niru® Knob-Top Runner MICROSTOP
14	LAUNDRY	T17 - Superfoam® 562 - Sanitop® MICROSTOP (Red only) 750 - V-Groove Runner (Rubber)	
15	PHARMACY/ GIFT SHOP	T17 - Superfoam® 117 - Heritage Rib® 118 - Arrow Trax™ GREENTRAX 130 - Sabre™ Decalon® 410 - Airug®	419 - Diamond Sof-Tred™ 470 - Marble Sof-Tyle™ REDSTOP 970 - Marble Sof-Tyle™ Grande™ REDSTOP Logo Mats
16	CHAPEL	130 - Sabre™ Decalon® 131 - Dante™ Decalon® 769 - Clear Trax™	
17	MAINTENANCE	T17 - Superfoam® 410 - Airug® 419 - Diamond Sof-Tred™ 479 - Cushion Trax® REDSTOP 562 - Sanitop® MICROSTOP (Red only)	830 - Switchboard Matting 831 - Diamond Switchboard Matting 950 - Knee RX Kneeling Pad 951 - Knee RX Heavy Duty Kneeling Pad

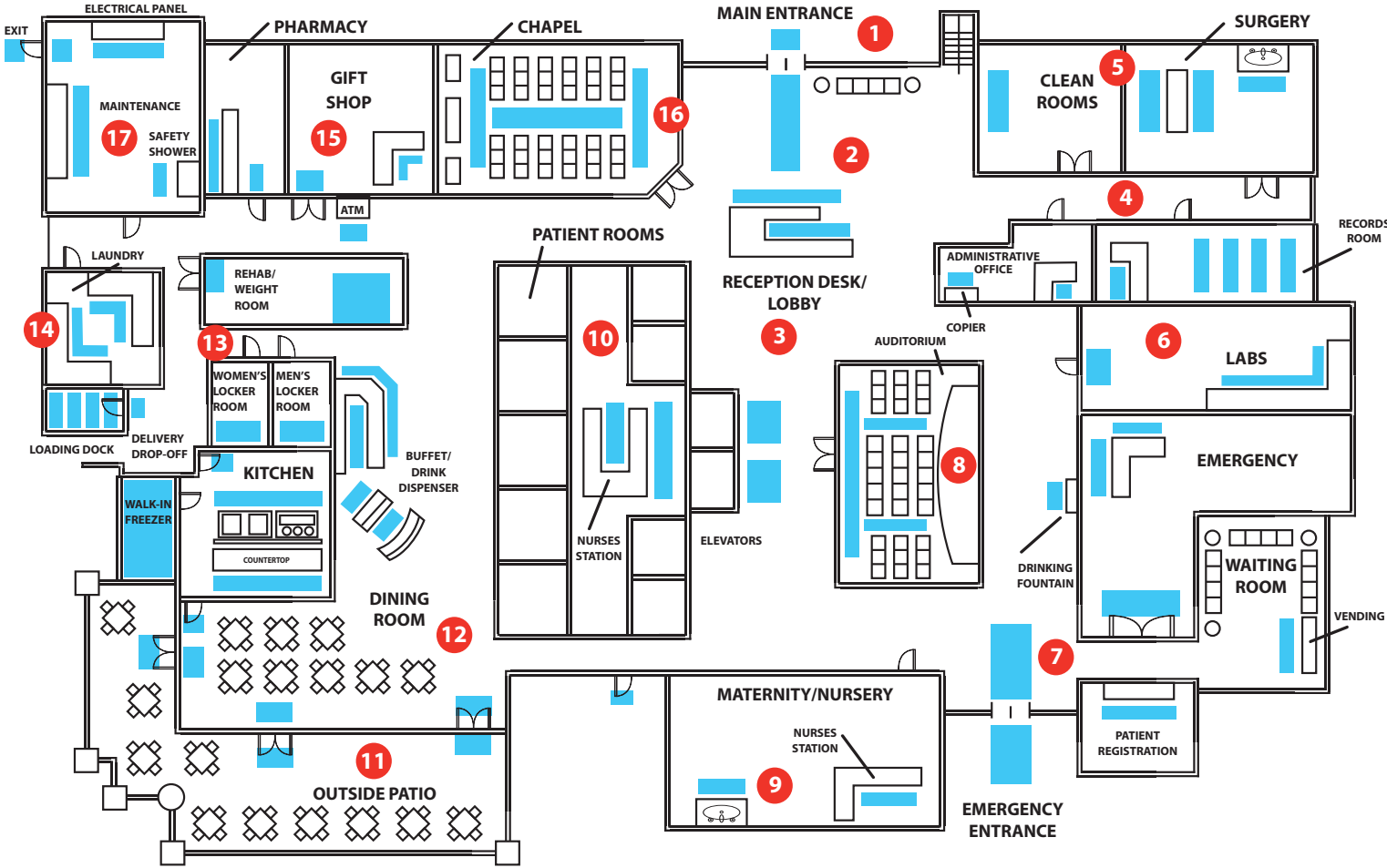

CHOOSING THE RIGHT MAT

YOUR MAT SELECTION SHOULD BE BASED ON FUNCTION-ALITY (SCRAPE-N-CLEAN, ANTI-FATIGUE, SAFETY), ENVIRONMENT (WET, DRY), QUALITY, AND VALUE.



Products featuring the MicroStop™ logo are made with a unique anti-microbial rubber compound that inhibits the growth of microorganisms such as bacteria, and fungi that can cause odor, stains, and product deterioration. Unlike anti-microbial treatments, MicroStop™ is incorporated directly into the mat during the manufacturing process so it cannot be washed off or wear away over time Floor matting products with MicroStop™ should be used in conjunction with standard cleaning and disinfecting practices in order to provide a cleaner and healthier work environment.



Products featuring the GreenTRAX™ logo are top-rated for use in “Green Cleaning” applications



A uniquely engineered anti-slip backing that virtually eliminates the slipping and sliding of NOTRAX® floor mats on all types of smooth floor surfaces such as vinyl composite tile, painted or epoxy coated concrete, vinyl sheet flooring, carpet, and ceramic tile.

LOCATION AND MAT RECOMMENDATION

LOCATION	GOOD BETTER BEST SUPERIOR SPECIALTY	DESCRIPTION
1 Main Entrance (Outside)	#231, 266**, 340**	**All weather mats to withstand the elements
2 Main Entrance (Inside)	#117, 118, 132, 136, 138, 139, 141, 146, 150, 161, 166, 370, Logo Mats	For functionality & Aesthetics in high traffic areas
3 Reception Desk/Lobby	#T17, 130, 166, 170, 410, 470, 970, Logo Mats	Comfort and aesthetics at the point of first contact
4 Office/Records	#T17, 410, 470, 479, 769, 825*, #970	*825 Anti-static matting for use with copiers or other sensitive machinery
5 Surgery/Clean Rooms	*#416, *662 w/ ramps	*Anti-Microbial/Anti-Bacterial properties for sensitive environments/washdown area
6 Labs	#T17, 470, 479, 662, 970, 975, 979	To provide cushioning and/or assists in prevention of slips and falls
7 Emergency	#T17, 117, 118, 132, 136, 138, 139, 141, 146, 150, 161, 166, 231, 266, 323, 340, 370, Logo Mats, 410, 411, 447, 470, 970	Areas include entrance, registration desk, waiting room, vending, nurses stations
8 Auditorium	#105, 117, 130, 769	To keep aisleways clean, provide anti-slip walking surface
9 Maternity/Nursery	#T17, 410, 447, 470, 970, 562, 662	To provide cushioning and/or assists in prevention of slips and falls/washdown area
10 Nurses Station	#T17, 410, 447, 470, 970	Cushioning comfort
11 Outside Patio	#117, 118, 146, 166, 167, 168, 231, 340**	**All weather mats to withstand the elements
12 Kitchen/Dining/Delivery	#T17, 117, 118, 130, 543, 550, 556, 562, 680*, 755, 758, 765, Cutting Boards	Some rubber kitchen mats are anti-microbial, (765) rated for cold temperatures *Anti slip pads for stairs or ramps, NSF approved cutting boards
13 Weight/Rehab/Locker Rooms	#045, 266, 411, 523, 531, 755, 758	Cushioning comfort, floor protection from weights/machinery, drainage and non-slip for showers/locker rooms
14 Laundry	#T17, 562, 750	Cushion comfort, runners for cart traffic areas
15 Pharmacy/Gift Shop	#T17, 117, 118, 130, 410, 419, 470, 970, Logo Mats	Comfort and aesthetics in a retail environment
16 Chapel	#130, 131, 769	To keep aisleways clean, provide anti-slip walking surface
17 Maintenance	#T17, 410, 419, 479, 562, 830, 831, 950, 951	Variety of applications: anti-static, non-conductive, anti-fatigue, kneeling mats